



Quayside House

Kew Bridge Road, Brentford, TW8 0HT

Asking Price £1,100,000

A Modern stylist two bed room apartment in a desirable waterfront development next to Kew Bridge. The property have two private balconies and benefits underground parking, as well as access to a range of on-site amenities including a concierge, residents' gym, and landscaped communal gardens. The apartment itself consists of a smart modern fitted kitchen, open-plan living room with wooden flooring and French windows.

A further range of shopping and dining opportunities are available on both sides of the bridge in Kew, Strand-on-the-Green and Chiswick. Kew Bridge Mainline and Gunnersbury Underground stations provide commuters with convenient transport connections into and out of the city centre.

Service charges : £6,100.00 per annum
Ground rent : £300.00 per annum
Lease length : 999 years

- 2 Bedrooms
- 24 hours Concierge
- Underground Parking
- Communal Gardens

Viewing

Please contact our Messila Residential Office on 020 7586 6699 if you wish to arrange a viewing appointment for this property or require further information.



Floor Plan

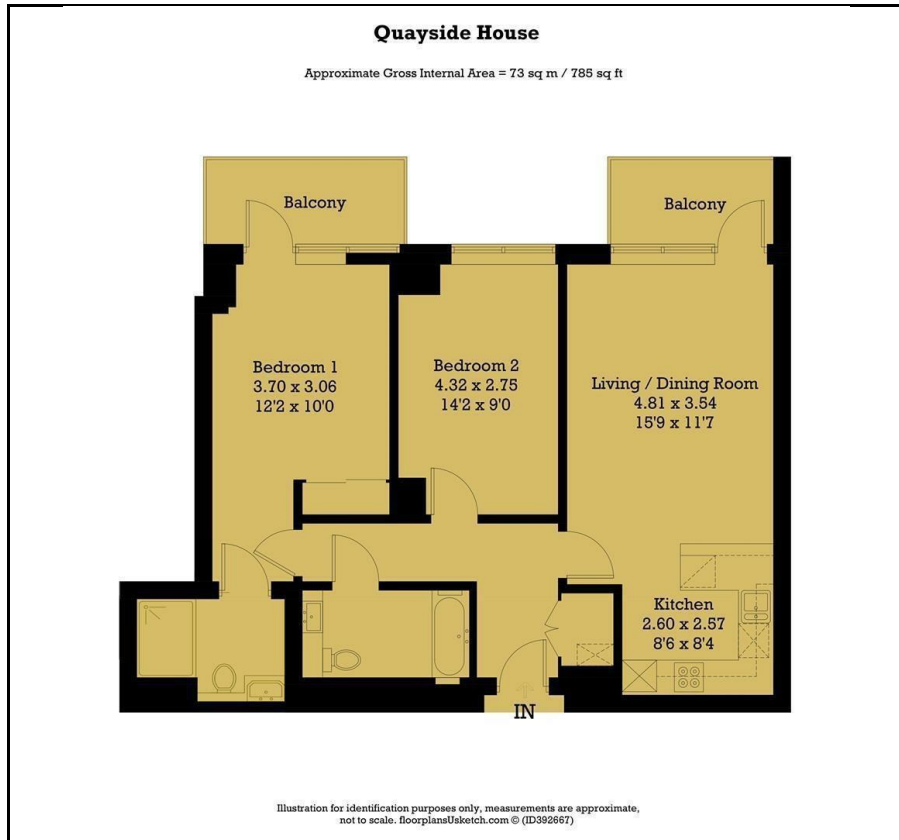

Area Map



Energy Efficiency Graph

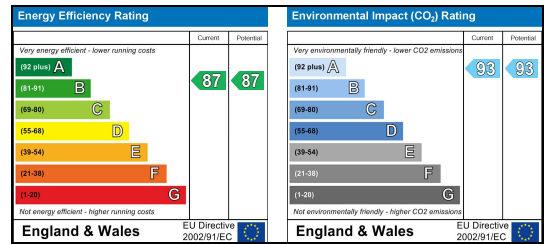

These particulars, whilst believed to be accurate are set out as a general outline only for guidance and do not constitute any part of an offer or contract. Intending purchasers should not rely on them as statements of representation of fact, but must satisfy themselves by inspection or otherwise as to their accuracy. No person in this firm's employment has the authority to make or give any representation or warranty in respect of the property.

Messila Residential

137 Park Road, London, NW8 7HT

T: 020 7586 6699 E: regentpark@messilaresidential.com W: messilaresidential.com